



4242 Baldwin Boulevard
Corpus Christi,
Texas 78405-3399
361-888-5591
800-531-3111
Fax: 361-888-6510
Fax: 800-531-3108
http://www.hortondoors.com

SPECIFICATION DETAILS

AUTOMATIC SLIDE DOORS - COMMERCIAL

SERIES 2000, 2001 & 2003
LOCKING

A8.6

3/01

Numerous locking options are offered to meet the job requirements. Depending on the degree of security desired, the door unit type, and the method of actuation, additional locking may be desired other than the locking of the slide operation.

Select the type locking desired by reviewing the following:

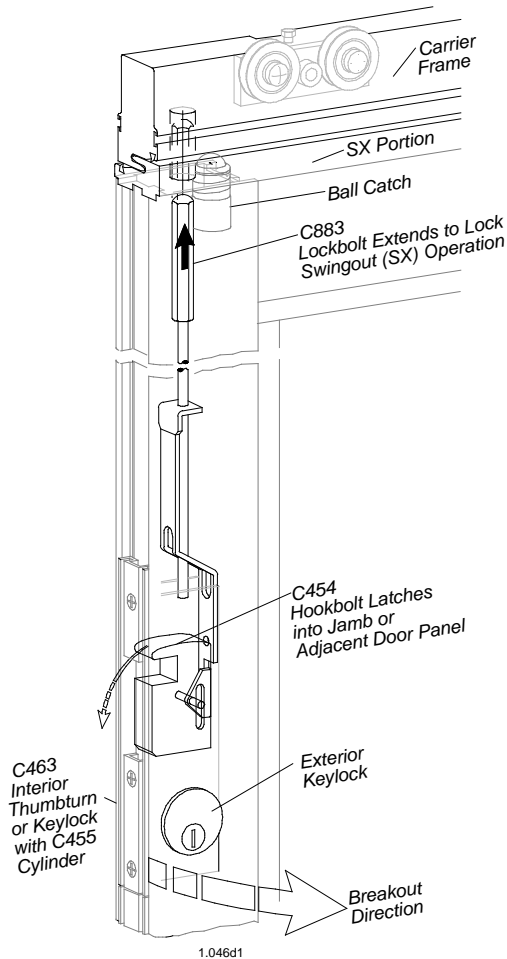

Ball Catch Latch:

The Safety To Life Code may require the sliding door to have the emergency breakout feature (SX). If the door is equipped with this feature, the swing out panel is not locked unless some type of locking for the swingout function is specified. Nonetheless, a measure of security is provided by a ball catch latch(see left) that releases when approximately 45 pounds of pressure is applied at the interior lock stile of the door.

Note: It is rather difficult to get sufficient grip from the exterior to open the door unless a hook device is used.

Maximum Security Manual Locking:

A lockbolt locks the swingout operation of the sliding panel into the top carrier frame (as an option, the lockbolt can be made to lock down into the threshold). An additional hookbolt latches into the jamb or adjacent door panel. Both are simultaneously operated by a thumbturn or keylock (see left). *Note: This is standard hardware on doors with the emergency breakout feature*

If it is desired that slide operation continue with the swing operation locked, the lockbolt and the hookbolt latch can be installed as separate locks with the lockbolt extended during normal operation. In case of emergency, a thumbturn installed on the inside unlocks the lockbolt and the panel is pushed out (check local codes to see if this method of unlocking in case of emergency is acceptable for the location of the door).

Panic Hardware:

If the location requires panic hardware, the type **310 SO-SX** unit is required. Panic hardware exit devices equal to **Adams Rite 8600** (concealed vertical rod) are required. It is installed on the sliding panel and locks the swing operation only.

Automatic Locking:

Horton Automatics manufactures two standard automatic locks (see following page) to inhibit the slide action of the door. Neither unit will inhibit the breakout "swing" action of the door panel (prohibited by Safety-To-Life standards). Both units are concealed with the operator in an aluminum header. The **Fail Secure Autolock** is Horton's most popular autolock which will remain locked and "secure" should 120 VAC power to the operator be interrupted. It requires power to retract and allow slide action of the door operator. The solenoid used is rated for continuous duty.

The second unit is a **Fail Safe Autolock** which will unlock during a power outage. It requires power to extend its bolt and lock the operator. As it will unlock should power be interrupted, this unit is typically requested only on non-breakout doors, or units that will have alternate locking methods for after-hours.

Both units are based on the same electromechanical design with the the return spring / solenoid armature reversed. Lubrication and adjustment schedules for the autolocks are similar to that required by the door and operator. An optional switch can be provided within the autolock that will signal a remote monitoring station that the door is in an unlocked condition. An additional switch can be mounted in the operator indicating the door is in the closed position. Horton can also provide a remote monitoring station, built to customer specifications.



4242 Baldwin Boulevard
 Corpus Christi,
 Texas 78405-3399
 361-888-5591
 800-531-3111
 Fax: 361-888-6510
 Fax: 800-531-3108
<http://www.hortondoors.com>

SPECIFICATION DETAILS

AUTOMATIC SLIDE DOORS - COMMERCIAL

SERIES 2000, 2001 & 2003
 AUTOLOCKS

A8.7

3/01

GENERAL AUTOLOCK OPERATION

- Open Signal is Received by Control (C2150)
- Unlock Signal is Sent to Autolock
- Solenoid Retracts Lockbolt
- Door Opens and Closes
- Solenoid Extends the Lockbolt When the Door is Fully Closed and the Keeper is in Locked Position
- Door Slide Motion, Only, is Locked

Linear Drive Autolock

C2176-5 Fail Secure (If Power Fails the Door Will Remain Locked)

C2196-5 Fail Safe (If Power Fails the Door Will Unlock)

2001 Belt Drive Autolock

C3976 Fail Secure (If Power Fails the Door Will Remain Locked)

C3977 Fail Safe (If Power Fails the Door Will Unlock)

2003 Belt Drive Autolock

C5656 Fail Secure (If Power Fails the Door Will Remain Locked)

C5657 Fail Safe (If Power Fails the Door Will Unlock)

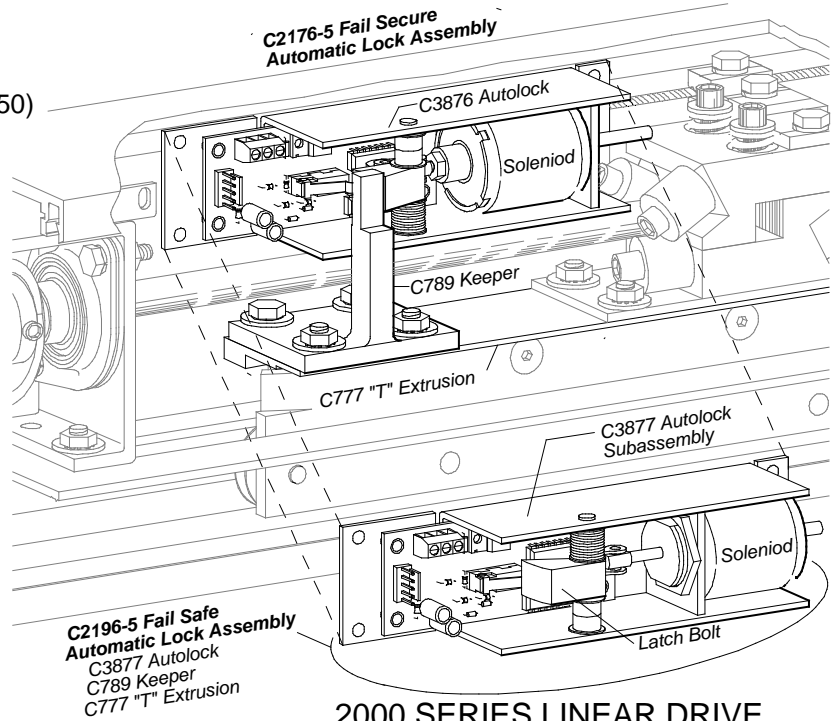

2000 SERIES LINEAR DRIVE

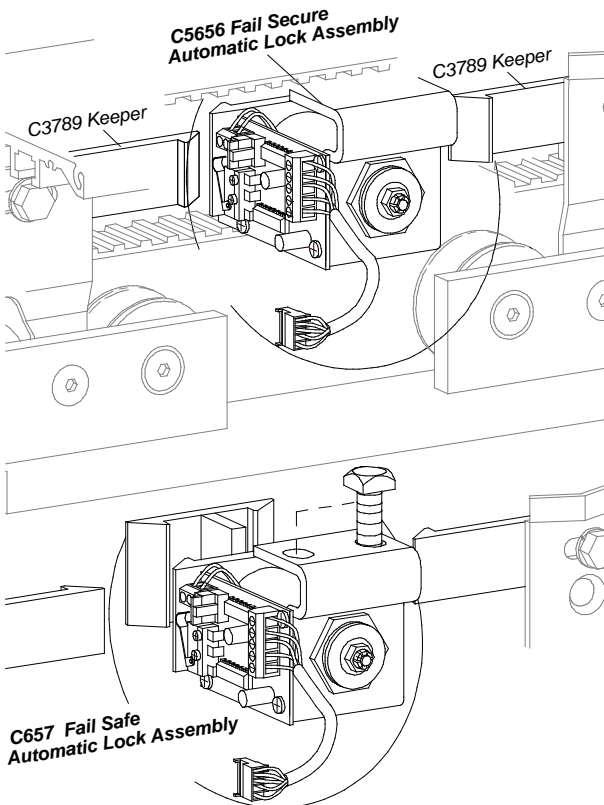

2003 SERIES BELT DRIVE

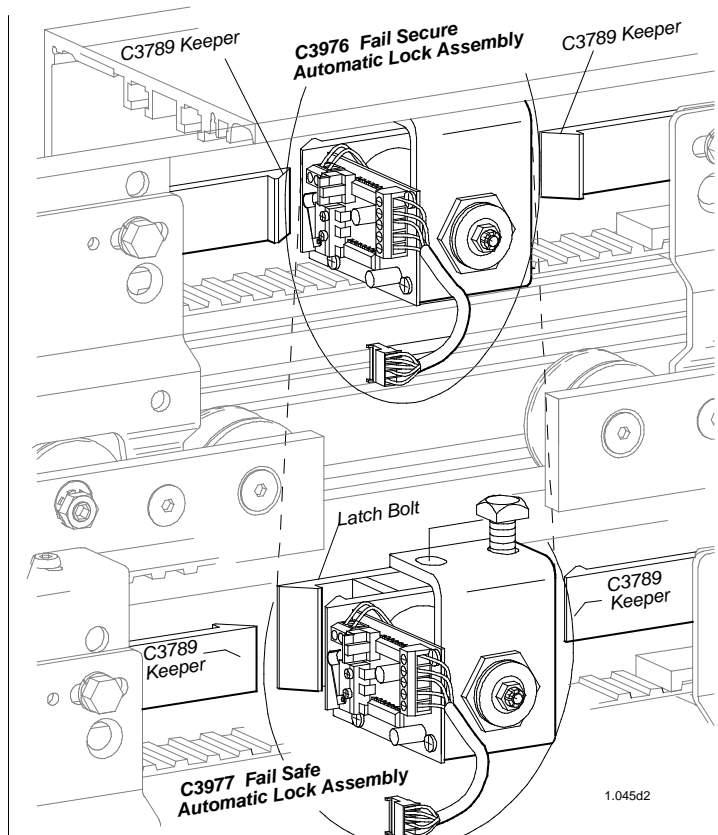

2001 SERIES BELT DRIVE

1.045d2